

Pat Wieland - FTS  
918 Big Mount Rd.  
Thomasville, PA 17364

717-891-8732 • wieland313@comcast.net

For more info and our coursing schedule, please visit our websites:

[www.hanoverlurecoursingclubs.com](http://www.hanoverlurecoursingclubs.com)

[www.asfaregion8.com](http://www.asfaregion8.com)

**Directions to Hanover Shoe Farms, Sells Station Road Site:**

**From West or South:** Rt. 97 to Littlestown. At the traffic light take Rt. 194 North to Sell Station Road. Left on Sell Station; 1.3 miles to site.

**From East and North:** Rt. 194 South out of Hanover. Sells Station Road is 0.8 miles past the main entrance to Hanover Shoe Farms. Turn right on Sell Station; 1.3 miles to the site.

**General Site Descriptions:** The Sells Station Road soccer complex is fenced and remote from busy roads. The weather may be hot, and field conditions vary from dry through wet and muddy. Please provide shade and water for your hounds.

**Map of area:**

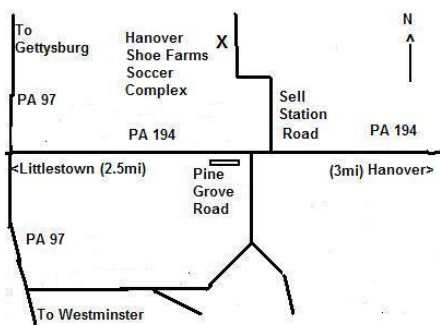

**Motels:**

Travelodge, Gettysburg PA 717-334-9281  
Boston Inn, Westminster, MD 800-634-0846  
1863 Inn of Gettysburg, Gettysburg, PA 717-334-6211  
Comfort Inn, Gettysburg, PA 717-337-2400  
Super 8-Gettysburg, Gettysburg, PA 717-337-1400  
Motel 6, York, PA 717-846-6260  
Econolodge, Hanover, PA 717-646-1000

**PREMIUM LIST**

EARLY ENTRIES CLOSE: Thurs, October 17, 2019, 6pm  
at the FTS's address: 918 Big Mount Rd. Thomasville, PA 17364  
DAY OF TRIAL ENTRIES CLOSE 30 minutes prior to roll call  
at the FTS's Table



Tortoise & Hare Lure Coursers

**ASFA ALL-BREED Region 8 REGIONAL INVITATIONAL**

**October 19 & 20, 2019**

**Hanover Soccer Complex**

**Sells Station Rd.**

**Littlestown, PA 17340**

**Cell Phone on site: 717-891-8732**

**Early-entry fee \$20.00 for the first hound entered;  
\$18.00 for additional hounds from the same household.  
Day of Trial Entry \$25 each**

**Regional Invitational Requirements:**

Any hound that is ASFA pointed or is pointed in its country of residence or is AKC pointed, is eligible to enter a Regional Invitational in an appropriate stake, including Single Stake, if offered. Proof of non-ASFA points for hounds should be in the form of a photocopy of the certificate, or a page of formal printing, included with the entry. For a Limited breed to be eligible, the entry must have one first placement, or two second placements, with competition in the Limited Stake. All points or placements must be earned by the closing date of the event. An eligible hound may be entered in any number of Regional Invitationals. Hounds entered in the Single Stake are not eligible to be entered in Breeder, Kennel, or Bench stakes.

T&HLC appreciates the continuing generosity of The Hanover Shoe Farms Inc. for permitting the use of their Soccer Complex for this event.

Permission has been granted by the American Sighthound Field Association for the holding of this event under ASFA Rules and Regulations.

**Audrey Silverstein, Chairperson, ASFA Scheduling Committee**

## Tortoise & Hare Lure Coursers 2019

Pat Wieland...**President**                      Celeste Mulcrone...**Vice President**  
 Sally Mac Dowell...**Secretary**                      Audrey Silverstein ...**Treasurer**  
**Directors:** Sally MacDowell, Beth Anne Haner, Dean Wright

### American Sighthound Field Association

Officers and Directors: **President**, Dean Wright – **President**

1<sup>st</sup> Vice President: Thomas Cigolle, Jr., 2<sup>nd</sup> Vice President Gregory Breibach,

**Corresponding Secretary** Holly Hamilton; **Recording Secretary**; Ping Pirrung;

**Chief Financial Officer**: Phil Fullam; **Region Directors- Region 1**: Jennifer

Vookles; **Region 2** : Jayme Jones, **Region 3**: Dan Heidel; **Region 4**: Gary Runyan;

**Region 5**: Trisha Borland; **Region 6**: Lee Warden; **Region 7**: Elaine McMichael;

**Region 8**: Kathy Sanders; **Region 9**: Cathy Sanderson;

**Region 10**: Jennifer Gysler

### JUDGES & ASSIGNMENTS

Diana Darling

Jim Dumais, Hanover, PA

\*\*Dr. Kammi Hefner, Pleasant Hall, PA\*\*

Judy Lowther, Cleveland, OH

Bob Marciszewski, Glen Arm, MD

Kathy Sanders, Linden, NJ

Dean Wright, Hanover, PA

S = Single Judge    \* = Provisional Judge    X = Multiple Judges

#### Saturday

Judges	A F	A Z	B A	B Z	C	G	I B	I G	I W	L C	P H	R R	S A	S D	S L	S W	W	L T	S G
Kammi	X	*	X	X	*	X	*												
Judy	X	X	X	X	X	X	X												
Bob								X	X	X	X	X	X						
Kathy								X	X	X	X	X	X						
Diana														X	X	X	X	X	X
Jim														X	X	X	X	X	X

#### Sunday

Judges	A F	A Z	B A	B Z	C	G	I B	I G	I W	L C	P H	R R	S A	S D	S L	S W	W	Ltd	S G
Kammi													X	*	*	*	X	*	
Judy								X	X	X	X	X	X						X
Bob	X	X	X	X	X	X	X												
Dean	X	X		X		X								X	X	X	X	X	X
Diana			X		X		X	X	X	X	X	X							

### FIELD COMMITTEE

Field Trial Chairman	Francis Byrne 301-240-285-5572 & Dean Wright 717-637-3011
Field Trial Secretary	Pat Wieland 918 Big Mount Rd. Thomasville, PA 717-891-9732 wieland313@comcast.net
Lure Operators	Dean Wright, Harry VanVliet, John Arvin, Borzoi Bob, Bob Jordan, Pat

	Wieland, Gayle Kytta, Francis Byrne, Jim Dumais
Field Clerks	Audrey Silverstein
Huntmasters	Borzoi Bob, Beth Ann Haner, Pat Wieland, John Arvin, Francis Byrne, Paul Kytta, Martin Del Prince
Inspection	Carol Smith, Bekki Pina, Linda Jordan

**TRIAL HOURS: 7:30am UNTIL AFTER RIBBONS ARE AWARDED.**

**Day of Trial entries close at 8:00am**

**Substitutions (same owner) until 8:00am day of trial**

**ROLL CALL: PROMPTLY at 8:30am**

**ENTRIES WILL NOT BE ACKNOWLEDGED BY RETURN MAIL OR PHONE**

**Ribbons or rosettes will be offered for all placements.**

**First=Blue, Second=Red, Third=Yellow, Fourth=White, NBQ=Green**

**Highest Scoring Single=Navy/Gold, Best of Breed=Purple/Gold,**

**& Best in Regional=Red, White & Blue.**

### ELIGIBLE BREEDS & REGISTRY

Only purebred Afghan Hounds, Azawakhs, Basenjis, Borzoi, Cimeco dell'Etna, Greyhounds, Ibizan Hounds, Irish Wolfhounds, Italian Greyhounds, Pharaoh Hounds, Rhodesian Ridgebacks, Salukis, Scottish Deerhounds, Silken Windhounds, Sloughis, and Whippets..

Limited breeds may be entered in the Limited Stake or the Singles Stake. Limited breeds currently include purebred Chart Polski, Galgo Español, Magyar Agar, Peruvian Inca Orchid, Portuguese Podengo (Pequeno), Portuguese Podengo (Medio & Grande), and must be individually registered with the appropriate registry.

All entries shall be individually registered with the AKC (ILP/PAL included), the NGA, the UKC, the FCI, an ASFA-recognized foreign or ASFA Board approved registry, or possess a CRN from the SPDBS. A photocopy of acceptable registry must be submitted with each hound's first ASFA field trial entry; this requirement is waived for hounds registered with the NGA.

### REGULAR STAKES OFFERED

**OPEN STAKE:** Any eligible sighthound that has met certification requirements, excluding ASFA Field Champions of record.

**FIELD CHAMPION STAKE:** Any ASFA Field Champion

**VETERAN STAKE:** Any eligible hound whose age is at least six years, except Irish Wolfhounds whose age shall be at least five years, and Afghan Hounds, Rhodesian Ridgebacks, Salukis and Whippets whose age shall be at least seven years. Points go toward V-FCh or V-LCM titles.

**LIMITED STAKE:** Any eligible sighthound of a Limited breed that has met certification requirements. Not eligible to compete in Best of Breed or Best in Field.

**SINGLE STAKE:** Any eligible sighthound including those disqualified to run in other stakes. Each hound runs alone. Not eligible for Best of Breed or Best in Field. Hounds are eligible to earn TCP and CPS titles from the Singles stake. Limited breeds are not eligible for these titles.

**Lure Coursing Instinct STAKE:** Open to all Non-Sighthound breeds. All entries shall be individually registered with the AKC (including ILP & PAL), the UKC, the FCI, an ASFA

recognized foreign or ASFA Board approved registry, or possess a CRN from the SPDBS. A photocopy of acceptable registry must be submitted with each dog's first ASFA field trial entry. Dogs without a recognized registry number may obtain an ASFA ID number for a \$10 registration fee at time of entry. This stake will be limited to a total of 20 entries.

**Small** is for dogs shorter than 17.5 inches at the withers and / or brachycephalic ("flat-faced") dogs.

**Large** is for dogs over 17.5 inches at the withers.

**Small** will run 50% of the course as laid out in this premium up to a maximum of 400 yards. All other sizes will run the full course length.

**Veterinarian on call:**

**Central Carroll Animal Emergency**

**1030 Baltimore Blvd. #180**

**Westminster, MD 21157**

**410-871-2000**

Go to [www.ASFA.org](http://www.ASFA.org)

for online Rulebook, Policies, Contacts, Clubs,  
Trial Schedules, Trial Results & much more.

## COURSE PLANS

### Saturday 770 yds

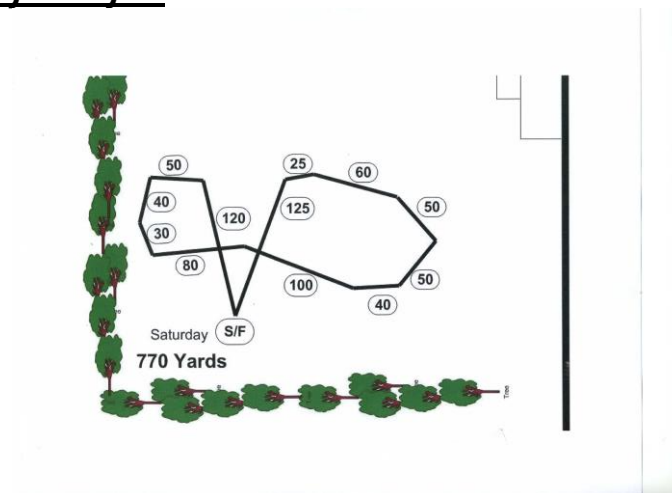

### Sunday 730yds

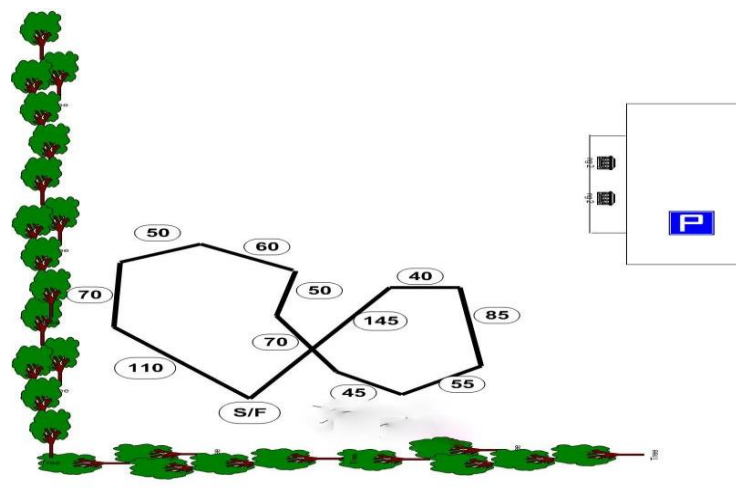

## NON-REGULAR STAKES OFFERED

**KENNEL STAKE:** For hounds of any individual breeds; an entry shall consist of two hounds, designated at time of entry, in one of the regular stakes being owned and kenneled by the same person.

**BREEDER STAKE:** For any eligible breed which shall have, designated at time of entry, two hounds bred by the same individual.

**BENCH STAKE:** For any eligible sighthound with proof on file with the ASFA of Conformation champion title from the AKC, CKC or both, or a conformation grand champion title from the UKC.

**BEST SINGLE IN EVENT:** Top Single, Saturday \* Sunday May compete in single runs on Sunday for Best Single in Event

**BEST IN FIELD WILL NOT BE OFFERED either day**

**BEST in EVENT WILL BE OFFERED ON SUNDAY, DOGS MUST BE ENTERED BOTH DAYS TO QUALIFY FOR BEST IN EVENT**

### CONDITIONS OF ENTRY

- All entries must be one year or older on the day of the trial.
- Stakes will be split into flights by public random draw if the entry in any regular stake is 20 or more.
- Bitches in season, lame hounds and hounds with breed disqualifications will be excused at roll call.
- Exhibitors are requested not to bring bitches known to be in season to the field
- Spayed, neutered, monorchid or cryptorchid hounds without breed disqualifications may be entered.
- Hounds with breed disqualifications are not eligible to enter except in the Single Stake.
- Hounds not present at the time of roll call will be scratched.
- ~ All hounds will run twice, in trios if possible or braces (except in the Single Stake), unless excused, dismissed or disqualified. The members of T&HLC reserve the right to alter the course plan as required by weather and/or field condition on the day of the trial.
- Each entry will be examined at inspection for breed disqualifications.

### Exhibitor Information

The course will be reversed for the finals, runoffs and Best of Breed. The members of T&HLC reserve the right to alter the course plan as required by weather and/or field conditions on the date of the trial. Exhibitors are requested to not bring bitches known to be in season to the field. There will be a \$5.00 fine assessed for any loose hound not participating in the course. Any person may, upon reasonable complaint, be asked to leave the grounds of the field trial by the Field Trial Committee. Bring your own shade and water. Lunch will be available for nominal fee.

**Equipment:** Type of lure machine: battery-powered continuous-loop system. Type of lures: highly-visible white plastic strip. Back-up equipment will be available.

**DISCLAIMER:** Upon entering this trial, the exhibitor agrees to hold harmless T&HLC, its members, and the event location (Hanover Shoe Farm) for any injury, loss, or damage sustained by person or hound. There will be no refund in the event that the trial has to be canceled due to weather or other

The field is fenced with typical board farm fencing.

ASFA Regional Rosettes will offered for all placement:

First=Blue  
Second=Red,  
Third=Yellow  
Fourth=White  
NBQ=Green  
High Score Single=Navy/Gold  
Best of Breed=Purple/Gold,  
Best in Regional=Red, White & Blue  
Bench, Kennel, and Breeder: pink/green

ASFA Medallions are awarded to each Best of Breed Winner  
Other prizes may be offered by T& HLC and friends

### Plaques for Saturdays Best of breed Winners to honor the following Region Eight Individuals

Afghans Bob and Linda Jordan  
Basenji Pete and Betty Smith  
Borzoi Leigh Littleton  
Greyhound Terry Fletcher  
Ibizan Hound Dean Wright  
Irish Wolfhound Tom Smith  
Italian Greyhound Don and Nancy Ewing  
Pharaoh Hound Pete and Camille Mendicino  
Rhodesian Ridgebacks Ian and Carlee Davies  
Salukis Peter and Carmen Day  
Scottish Deerhounds Bob and Norma Sellers  
Whippets Jack McManus

## **Regional Perpetual Trophies Best of Breed Sunday**

Afghan The Annie Trophy: Awarded to Best of Breed Afghan. Donated by Bob & Linda Jordan

Basenji: Betty & Pete Smith Trophy: Awarded to best of Breed Basenji in memory of Betty & Pete Smith

The Joey Trophy: In honor of Kenset Fire bird, LCM3 Can FCH. Donated by Jane & Pete Schreiber. (for the Basenji with the highest preliminary score, not necessarily Best of Breed)

Midnight Trophy: In honoring "Midnight" MBIF FC Thor's East of Midnight MC, LCX5, LCM6 -- Awarded to Best of Breed. Donated by Judy Brader

Borzoi: G'Kar Memorial Trophy: In commemoration of FC SilkenSwift Flurry's G'Kar MC LCM2 V-FCH, CGC. Awarded to the Best of Breed Borzoi. Donated by Sally MacDowell & "Borzoi Bob" Marciszewski

In honor of Rescue Greyhounds: Donated by Mike Chang, Winston & Caroline Copeland, Evelyn Jones, Pete & Camille Mendicino, Cathey Schuchman

Quinlan Trophy: In honor of all coursing wolfhounds. Awarded to Best of Breed Irish Wolfhound. Donated by Doug Henry & Diana Vreeken

Rhodesian Ridgeback: The "Aslan" Trophy: In Loving Memory of Finny. Awarded to Best of Breed Rhodesian. Donated by Ian & Carlee Davies

Scottish Deerhound: The Sophie Trophy: In honor of CH Silver Heels of Vale Vue SC III LCM3 Region 8 Best of Breed Winner 1989 & 1990. Awarded to Best of Breed Scottish Deerhound. Donated by Ellen Bonacarti.

Whippet: Angel and Camille Trophy: In memory of FC Carbeth's Angel CD, SC LCM9 and her daughter FC Carbeth's Loud and Clear SC LCM15 XV ROMX. Awarded to **Best of Breed** Whippet. Donated by Libby & Fritz Kirchner

**THERE WILL BE A REGIONAL DINNER FOLLOWING SATURDAYS TRIAL  
ON THE FIELD PLEASE JOIN US**

**THE MENU IS STILL TO BE DETERMINED**

## **OTHER INFORMATION**

- All entries must be one year or older on the day of the trial
- Stakes will be split into flights by public random draw if the entry in any regular stake is 20 or more
- Bitches in season, lame hounds and hounds with breed disqualifications will be excused at roll call. Spayed, neutered, monorchid or cryptorchid hounds without breed disqualifications may be entered.
- Hounds with breed disqualifications are not eligible to enter except in the Single Stake
- Hounds not present at the time of roll call will be scratched
- All hounds will run twice, in trios if possible or braces (except in the Single Stake), unless excused, dismissed or disqualified.

**Battery powered, continuous loop lure machines will be used. The lure will consist of white plastic strips. Backup equipment will be available. The course will be reversed for the finals, runoffs and Best of Breed.**

**The members of T&HLC reserve the right to alter the course plan as required by weather and/or field conditions on the date of the trial. Exhibitors are requested to not bring bitches known to be in season to the field.**

**There will be a \$5.00 fine assessed for any loose hound not participating in the course.**

**Any person may, upon reasonable complaint, be asked to leave the grounds of the field trial by the Field Trial Committee.**

**The field is board fenced; camping is permitted, but there is NO electricity or water.**

**Children must be under control of their parents or guardians at all times.**

**ALL RETURNED CHECKS WILL BE CHARGED A \$40 FEE.**

**PLEASE CLEAN UP AFTER YOURSELVES AND YOUR HOUNDS!!!**

**LUNCH will be available for \$5 after judges and workers eat.**

**RV parking is available, no hookups.**

# OFFICIAL AMERICAN SIGHTHOUND FIELD ASSOCIATION ENTRY FORM

## Tortoise & Hare Lure Coursers

### REGION 8 INVITATIONAL

**Saturday, October 19, 2019**

Early entries close **6pm Oct 17th, 2019** at the FTS's residence.

Early entry fees: **\$20 for the first hound, \$18 for each additional hound**

Day of trial entry fee: **\$25 each hound**

(Substitutions, same owner, until **8am day of trial**)

Make checks payable (in US funds) to **T&HLC** and mail to:

**Pat Wieland 918 Big Mount Rd Thomasville PA 17364**

Fee Paid \_\_\_\_\_ The Field Secretary cannot accept conditional, unsigned, incomplete or unpaid entries; please check your completed entry carefully.

Breed:		Call Name:	
Registered Name of Hound:			
Stake: <input type="checkbox"/> LCI-Small <input type="checkbox"/> LCI-Large <input type="checkbox"/> LCA-Small <input type="checkbox"/> LCA-Large <input type="checkbox"/> Open <input type="checkbox"/> FCH <input type="checkbox"/> Veteran <input type="checkbox"/> Single <input type="checkbox"/> Limited		Additional Stakes <input type="checkbox"/> Kennel <input type="checkbox"/> Breeder <input type="checkbox"/> Bench	
Registration Number: (please write in registering body before number)			
<input type="checkbox"/> If possible, please separate my hounds		Date of Birth:	Sex: <input type="checkbox"/> Dog <input type="checkbox"/> Bitch
Name of actual owner(s):			
Address:		Phone:	
City:		State:	Zip:
E-mail (Optional)		(Optional) Region of Residence:	
Emergency Contact Name and Phone (Optional)			
<input type="checkbox"/> Check if this is the first ASFA trial for this hound. Attach a Hound Certification or waiver if entered in Open, Veterans, Limited.			
<input type="checkbox"/> Check if this is a first-time entry, a copy of the official Registration of this hound must accompany this entry unless NGA.			
<input type="checkbox"/> Check if any information has changed since the last ASFA trial entry. Regarding _____			
<input type="checkbox"/> Check if this hound has been dismissed within the last 6 trials entered. Must be marked in order to qualify for a "clean" trial requirement.			

I CERTIFY that I am the actual owner of this dog, or that I am the duly authorized agent of the actual owner whose name I have entered above. In consideration of the acceptance of this entry and the opportunity to have this dog judged and to win prize money, ribbons, or trophies, I (we) agree to abide by the rules and regulations of the American Sighthound Field Association in effect at the time of this lure field trial, and by any additional rules and regulations appearing in the premium list for this lure field trial. I (we) agree that the club holding this lure field trial has the right to refuse this entry for cause, which the club shall deem to be sufficient. I (we) agree to hold this club, its members, directors, governors, officers, agents or other functionaries, any employees of the aforementioned parties and the owner(s) of the trial premises or grounds harmless from any claim for loss or injury which may be alleged to have been caused directly or indirectly to any person or thing by the act of this dog while in or upon the lure field trial premises or grounds or near any entrance thereto and I (we) personally assume all responsibility and liability for any such claim, and I (we) further agree to hold the aforementioned parties harmless from any claim loss of this dog by disappearance, theft damage or injury be caused or alleged to be caused by the negligence of the club or any of the aforementioned parties or by the negligence of any person or any other cause or causes. I (we) certify and represent that the dog entered is not a hazard to person or other dogs. This entry is submitted for acceptance of the forgoing representations and agreements.

**SIGNATURE** of owner or his agent  
duly authorized to make this entry \_\_\_\_\_

# OFFICIAL AMERICAN SIGHTHOUND FIELD ASSOCIATION ENTRY FORM

## Tortoise & Hare Lure Coursers

### REGION 8 INVITATIONAL

**Sunday, October 20, 2019**

Early entries close **6pm Oct 17th, 2019** at the FTS's residence.

Early entry fees: **\$20 for the first hound, \$18 for each additional hound**

Day of trial entry fee: **\$25 each hound**

(Substitutions, same owner, until **8am day of trial**)

Make checks payable (in US funds) to **T&HLC** and mail to:

**Pat Wieland 918 Big Mount Rd Thomasville PA 17364**

Fee Paid \_\_\_\_\_ The Field Secretary cannot accept conditional, unsigned, incomplete or unpaid entries; please check your completed entry carefully.

Breed:		Call Name:	
Registered Name of Hound:			
Stake: <input type="checkbox"/> LCI-Small <input type="checkbox"/> LCI-Large <input type="checkbox"/> LCA-Small <input type="checkbox"/> LCA-Large <input type="checkbox"/> Open <input type="checkbox"/> FCH <input type="checkbox"/> Veteran <input type="checkbox"/> Single <input type="checkbox"/> Limited		Additional Stakes <input type="checkbox"/> Kennel <input type="checkbox"/> Breeder <input type="checkbox"/> Bench	
Registration Number: (please write in registering body before number)			
<input type="checkbox"/> If possible, please separate my hounds		Date of Birth:	Sex: <input type="checkbox"/> Dog <input type="checkbox"/> Bitch
Name of actual owner(s):			
Address:		Phone:	
City:		State:	Zip:
E-mail (Optional)		(Optional) Region of Residence:	
Emergency Contact Name and Phone (Optional)			
<input type="checkbox"/> Check if this is the first ASFA trial for this hound. Attach a Hound Certification or waiver if entered in Open, Veterans, Limited.			
<input type="checkbox"/> Check if this is a first-time entry, a copy of the official Registration of this hound must accompany this entry unless NGA.			
<input type="checkbox"/> Check if any information has changed since the last ASFA trial entry. Regarding _____			
<input type="checkbox"/> Check if this hound has been dismissed within the last 6 trials entered. Must be marked in order to qualify for a "clean" trial requirement.			

I CERTIFY that I am the actual owner of this dog, or that I am the duly authorized agent of the actual owner whose name I have entered above. In consideration of the acceptance of this entry and the opportunity to have this dog judged and to win prize money, ribbons, or trophies, I (we) agree to abide by the rules and regulations of the American Sighthound Field Association in effect at the time of this lure field trial, and by any additional rules and regulations appearing in the premium list for this lure field trial. I (we) agree that the club holding this lure field trial has the right to refuse this entry for cause, which the club shall deem to be sufficient. I (we) agree to hold this club, its members, directors, governors, officers, agents or other functionaries, any employees of the aforementioned parties and the owner(s) of the trial premises or grounds harmless from any claim for loss or injury which may be alleged to have been caused directly or indirectly to any person or thing by the act of this dog while in or upon the lure field trial premises or grounds or near any entrance thereto and I (we) personally assume all responsibility and liability for any such claim, and I (we) further agree to hold the aforementioned parties harmless from any claim loss of this dog by disappearance, theft damage or injury be caused or alleged to be caused by the negligence of the club or any of the aforementioned parties or by the negligence of any person or any other cause or causes. I (we) certify and represent that the dog entered is not a hazard to person or other dogs. This entry is submitted for acceptance of the forgoing representations and agreements.

**SIGNATURE** of owner or his agent  
duly authorized to make this entry \_\_\_\_\_

**AMERICAN SIGHTHOUND FIELD ASSOCIATION  
HOUND CERTIFICATION**

**Rule effective October 1, 1994: Ch. V, Sec. 4 (a) OPEN STAKE:** *To be eligible to enter the open stake, a hound must have been certified by a licensed judge within the year preceding the closing date for the entry or have previously competed in the Open Stake.* This eligibility requirement also applies to a hound entered in the Limited or Veteran Stake, which has not competed in Open previously. Please complete this portion of this form and attach it to the entry form for the hound's first entry, including an entry for a Fun Trial.

Registered Name of Hound: \_\_\_\_\_

Registration Number: \_\_\_\_\_ Breed: \_\_\_\_\_

Registered Owner's Name: \_\_\_\_\_

I hereby certify that on (date) \_\_\_\_\_, the above named hound completed a lure course of at least 500 yards, running with another hound of the same breed (or another breed with a similar running style). During the course the above named hound showed no inclination to interfere with the other hound. I further certify that I am a licensed judge for the ASFA.

Name of Licensed Judge: \_\_\_\_\_

Signature: \_\_\_\_\_ Date: \_\_\_\_\_

I hereby certify that the hound running in the certification course is the hound identified above and that information provided on this form is true and correct.

Signature: \_\_\_\_\_ Date: \_\_\_\_\_

Owner or Authorized Agent of Hound

This certification form must be attached to the entry form the first time this hound is entered in an open, limited, or veteran stake. Any hound entered in open, limited, or veteran (as a first time entered hound), which has not been certified, shall be declared ineligible by the records coordinator and shall forfeit any points and placements awarded.

**PLEASE RETAIN A COPY FOR YOUR RECORDS.**

**AMERICAN SIGHTHOUND FIELD ASSOCIATION  
HOUND CERTIFICATION WAIVER**

**Waiver of Requirement:** *This requirement will be waived for a hound that has earned a lure coursing or racing title from another recognized organization, if such title requires competition, and if a waiver for such title has been approved by the ASFA, or a CKC Hound Certification Form.* If your hound qualifies for a waiver, complete this portion of this form and attach it to your entry form. Proof of waivers must accompany this certification form.

Registered Name of Hound: \_\_\_\_\_

Registration Number: \_\_\_\_\_ Breed: \_\_\_\_\_

Registered Owner's Name: \_\_\_\_\_

**CKC:** FCH FCHS

**AKC:** QC SC FC

Hound Certification previously submitted.

I hereby certify that the hound identified above has completed the requirements for the title indicated above (or that the required Certification was previously submitted) and that the information provided on this form is true and correct.

Signature: : \_\_\_\_\_ Date: \_\_\_\_\_

\_\_\_\_\_ Owner or Authorized Agent of Hound \_\_\_\_\_

**AMERICAN SIGHTHOUND FIELD ASSOCIATION  
HOUND CERTIFICATION**

**Rule effective October 1, 1994: Ch. V, Sec. 4 (a) OPEN STAKE:** *To be eligible to enter the open stake, a hound must have been certified by a licensed judge within the year preceding the closing date for the entry or have previously competed in the Open Stake.* This eligibility requirement also applies to a hound entered in the Limited or Veteran Stake, which has not competed in Open previously. Please complete this portion of this form and attach it to the entry form for the hound's first entry, including an entry for a Fun Trial.

Registered Name of Hound: \_\_\_\_\_

Registration Number: \_\_\_\_\_ Breed: \_\_\_\_\_

Registered Owner's Name: \_\_\_\_\_

I hereby certify that on (date) \_\_\_\_\_, the above named hound completed a lure course of at least 500 yards, running with another hound of the same breed (or another breed with a similar running style). During the course the above named hound showed no inclination to interfere with the other hound. I further certify that I am a licensed judge for the ASFA.

Name of Licensed Judge: \_\_\_\_\_

Signature: \_\_\_\_\_ Date: \_\_\_\_\_

I hereby certify that the hound running in the certification course is the hound identified above and that information provided on this form is true and correct.

Signature: \_\_\_\_\_ Date: \_\_\_\_\_

Owner or Authorized Agent of Hound

This certification form must be attached to the entry form the first time this hound is entered in an open, limited, or veteran stake. Any hound entered in open, limited, or veteran (as a first time entered hound), which has not been certified, shall be declared ineligible by the records coordinator and shall forfeit any points and placements awarded.

**PLEASE RETAIN A COPY FOR YOUR RECORDS.**

**AMERICAN SIGHTHOUND FIELD ASSOCIATION  
HOUND CERTIFICATION WAIVER**

**Waiver of Requirement:** *This requirement will be waived for a hound that has earned a lure coursing or racing title from another recognized organization, if such title requires competition, and if a waiver for such title has been approved by the ASFA, or a CKC Hound Certification Form.* If your hound qualifies for a waiver, complete this portion of this form and attach it to your entry form. Proof of waivers must accompany this certification form.

Registered Name of Hound: \_\_\_\_\_

Registration Number: \_\_\_\_\_ Breed: \_\_\_\_\_

Registered Owner's Name: \_\_\_\_\_

**CKC:** FCH FCHS

**AKC:** QC SC FC

Hound Certification previously submitted.

I hereby certify that the hound identified above has completed the requirements for the title indicated above (or that the required Certification was previously submitted) and that the information provided on this form is true and correct.

Signature: \_\_\_\_\_ Date: \_\_\_\_\_

\_\_\_\_\_ Owner or Authorized Agent of Hound \_\_\_\_\_

### Kennel & Breeder Stake Entry

One form per pair of hounds per Stake

Check one or both: Kennel Stake Breeder Stake Bench Stake

Check one or both: Saturday Sunday

Breed: \_\_\_\_\_

Breeder(s): \_\_\_\_\_

Hound #1

Call Name: \_\_\_\_\_

Registered Name: \_\_\_\_\_

Owner(s): \_\_\_\_\_

Hound #2:

Call Name: \_\_\_\_\_

Registered Name: \_\_\_\_\_

Owner(s): \_\_\_\_\_

Please include \$5 per pair of hounds for EACH non-reg

### Kennel & Breeder Stake Entry

One form per pair of hounds per Stake

Check one or both: Kennel Stake Breeder Stake Bench Stake

Check one or both: Saturday Sunday

Breed: \_\_\_\_\_

Breeder(s): \_\_\_\_\_

Hound #1

Call Name: \_\_\_\_\_

Registered Name: \_\_\_\_\_

Owner(s): \_\_\_\_\_

Hound #2:

Call Name: \_\_\_\_\_

Registered Name: \_\_\_\_\_

Owner(s): \_\_\_\_\_

Please include \$5 per pair of hounds for EACH non-reg

### Kennel & Breeder Stake Entry

One form per pair of hounds per Stake

Check one or both: Kennel Stake Breeder Stake Bench Stake

Check one or both: Saturday Sunday

Breed: \_\_\_\_\_

Breeder(s): \_\_\_\_\_

Hound #1

Call Name: \_\_\_\_\_

Registered Name: \_\_\_\_\_

Owner(s): \_\_\_\_\_

Hound #2:

Call Name: \_\_\_\_\_

Registered Name: \_\_\_\_\_

Owner(s): \_\_\_\_\_

Please include \$5 per pair of hounds for EACH non-reg

### Kennel & Breeder Stake Entry

One form per pair of hounds per Stake

Check one or both: Kennel Stake Breeder Stake Bench Stake

Check one or both: Saturday Sunday

Breed: \_\_\_\_\_

Breeder(s): \_\_\_\_\_

Hound #1

Call Name: \_\_\_\_\_

Registered Name: \_\_\_\_\_

Owner(s): \_\_\_\_\_

Hound #2:

Call Name: \_\_\_\_\_

Registered Name: \_\_\_\_\_

Owner(s): \_\_\_\_\_

Please include \$5 per pair of hounds for EACH non-reg



*You can make a difference, even if you can help out for an hour or so.. Easy ways to volunteer at a lure coursing field trial (and you don't even have to be a T&HLC member):*

### **Field Setup**

◆ Come early (one hour before roll call) and start by carrying equipment.

◆ Learn as you go how to place pulleys and tie downs, eventually

### **Field Clerk**

◆ Volunteer to help the field clerk for even one or two breeds

◆ Learn how scores are tabulated and recorded - when you are comfortable with this you will be able to start helping the field trial secretary.

◆ The benefit is you will get a whole new perspective on the course and may learn by listening to the judges.

### **Runner**

◆ Volunteer to run paperwork from the field clerk to the field trial secretary after each breed has run.

◆ Scores can only be posted as quickly as the paperwork is delivered to the field trial secretary.

### **Lure Operator**

◆ Hang around and talk to the lure operator between courses

◆ If you are interested, try running the lure around before the trial, at lunch or after the trial at practice.

### **Practice**

◆ Give the volunteers who have been working all day a break!

◆ Take the practice list, call out the names and collect the money.

### **Fundraiser**

◆ It's great when people donate things, but even better if you can organize and execute a fundraiser whether it be a 50/50 draw, silent auction, raffle etc. It doesn't have to be complicated or too time consuming.

◆ Feel free to do this at any T&HLC trial!

### **THANK YOU FOR VOLUNTEERING.**

*Everyone will appreciate your efforts, and the trial will run more smoothly.*

**Whether or not you are a T&HLC member,  
please consider volunteering at this trial weekend.**

If you have experience and are willing to work a job or if you wish to apprentice to learn a job, please fill out the form below and return it with your entry to the Field Trial Secretary. As an apprentice you will be paired with a person who knows the job so that you will have one-on-one attention.

1. I will work on: \_\_\_\_ Saturday \_\_\_\_ Sunday

I will apprentice on: \_\_\_\_ Saturday \_\_\_\_ Sunday

Name: \_\_\_\_\_

Phone: \_\_\_\_\_

Email: \_\_\_\_\_

2. I am entering dogs of these breeds on Saturday:

\_\_\_\_\_

I am entering dogs of these breeds on Sunday:

\_\_\_\_\_

3. Check jobs you are willing to do or learn the day of the trial.

### **EXPERIENCED APPRENTICE**

Field Set UP \_\_\_\_\_

Roll Call \_\_\_\_\_

Paddock \_\_\_\_\_

Huntmaster \_\_\_\_\_

Lure Operator \_\_\_\_\_

Field Clerk \_\_\_\_\_

Field Tear Down \_\_\_\_\_

### **THANK YOU FOR VOLUNTEERING**

Your efforts will be greatly appreciated and the trial will run more smoothly.